

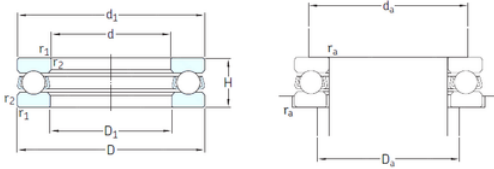

PFG BEARING LIMITED

skf 51109 bearing



Bearing No. 51109

51109 Bearing 2D drawings and 3D CAD models

Size	45x65x14 mm
Bore Diameter	45 mm
Outer Diameter	65 mm
Width	14 mm
d	45 mm
D	65 mm
H	14 mm
d1	65 mm
r1 min.	0,6 mm
r2 min.	0,6 mm
D1	47 mm
da min.	57 mm
Da max.	53 mm
ra max.	0,6 mm
Weight	0,14 Kg
Basic dynamic load rating (C)	26,5 kN
Basic static load rating (C0)	69,5 kN
Fatigue load limit (Pu)	2,55
Reference speed	4500 r/min
Limiting speed	6300 r/min
Category	Thrust Ball Bearing
Inventory	0.0
Manufacturer Name	SKF
Minimum Buy Quantity	N/A
Weight / Kilogram	0.154
EAN	7316576677359



PFG BEARING LIMITED

Product Group	B00308
Rolling Element	Ball Bearing
Thrust Bearing	Yes
Single or Double Direction	Single Direction
Banded	No
Cage Material	Steel
Precision Class	ABEC 1 ISO P0
Component Description	Roller Assembly Plus Raceways
Other Features	Single Row
Long Description	45MM Bore 1; 47MM Bore 2; 65MM Outside Diameter; 14MM Height; Ball Bearing; Single Direction; Not Banded; Steel Cage; ABEC 1 ISO P0 Precision
Inch - Metric	Metric
Category	Thrust Ball Bearings
UNSPSC	31171507
Harmonized Tariff Code	8482.10.50.08
Noun	Bearing
Keyword String	Ball Thrust
Manufacturer URL	http://www.skf.com
Manufacturer Item Number	51109
Weight / LBS	0.339
Overall Height with Aligning Washer	0 Inch 0 Millimeter
Outside Diameter	2.559 Inch 65 Millimeter
Height	0.551 Inch 14 Millimeter
Bore 2	1.85 Inch 47 Millimeter
Bore 1	1.772 Inch 45 Millimeter
bore diameter:	45 mm
static load capacity:	69.5 kN
outside diameter:	65 mm



PFG BEARING LIMITED

dynamic load capacity:	26.5 kN
overall width:	14 mm
maximum rpm:	6300 RPM
thrust bearing type:	Single-Direction
cage material:	Steel
outside diameter design:	Straight
fillet radius:	0.6 mm
separable or banded:	Separable
series:	511
precision rating:	ABEC 1 (ISO Class Normal)
d_1	65 mm
D_1	47 mm
$r_{1,2}$ min.	0.6 mm
d_a min.	57 mm
D_a max.	53 mm
r_a max.	0.6 mm
Basic dynamic load rating C	26.5 kN
Basic static load rating C_0	69.5 kN
Fatigue load limit P_u	2.55 kN
Minimum load factor A	0.025
Mass bearing (including seat washer where applicable)	0.14 kg